

Note
Contours shown are existing

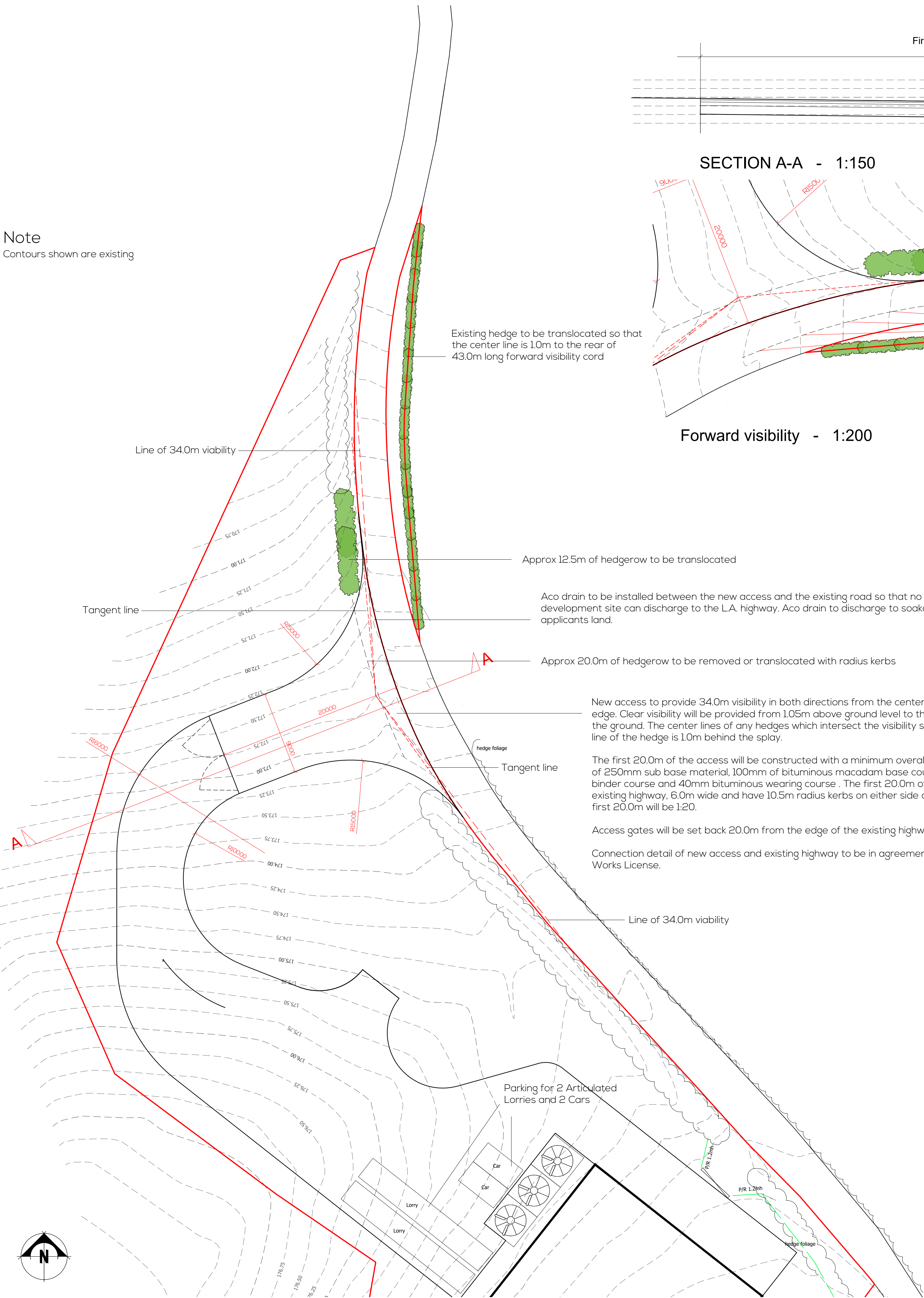

Access Plan - 1:250

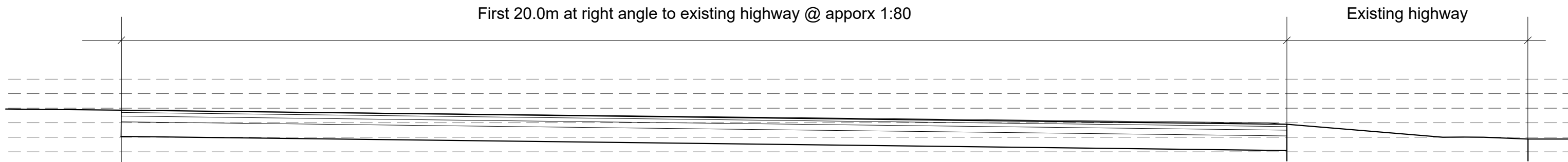

SECTION A-A - 1:150

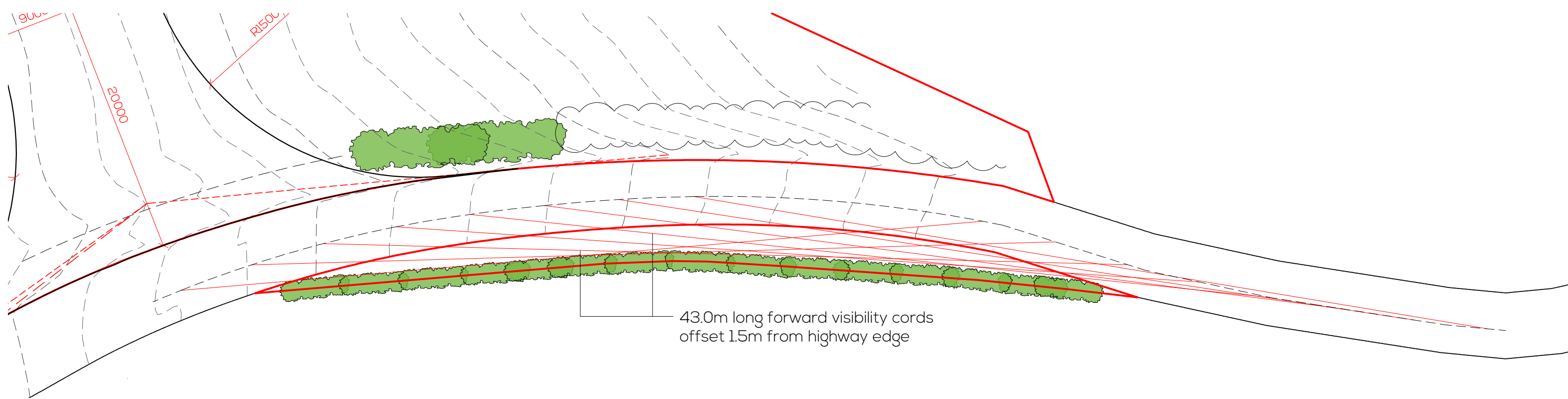

Forward visibility - 1:200

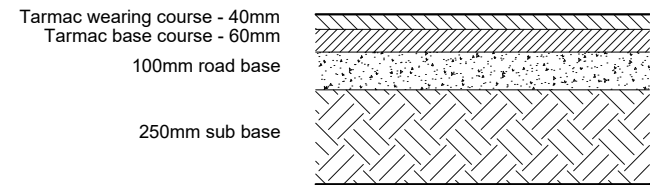

Access construction detail - 1:20

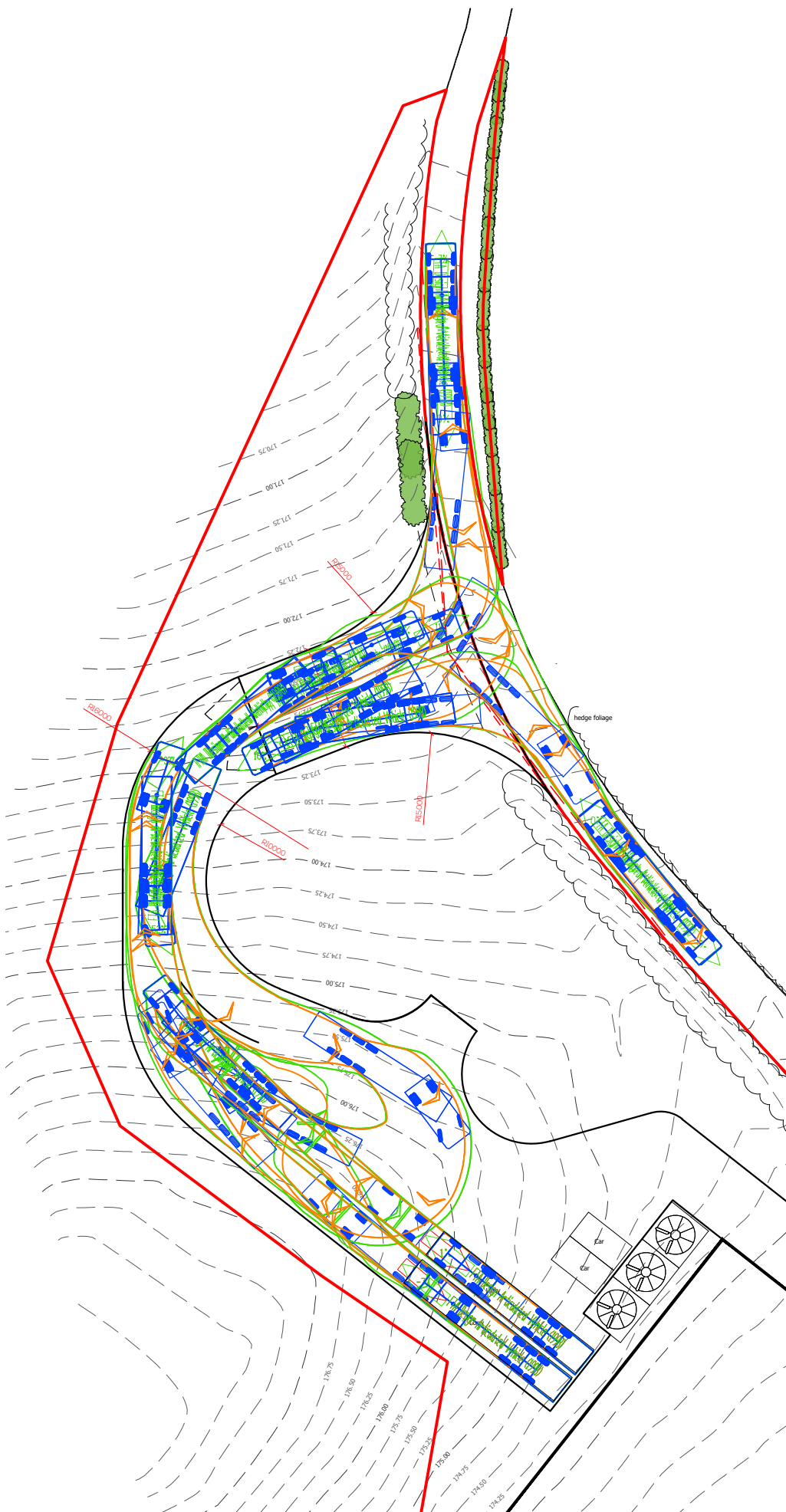

Block Plan - 1:250 - With Swept Path

THIS DRAWING IS TO BE READ IN CONJUNCTION WITH ALL RELATED DRAWINGS. ALL DIMENSIONS MUST BE CHECKED AND VERIFIED ON SITE BEFORE COMMENCING ANY WORK OR PRODUCING SHOP DRAWINGS. THE ORIGINATOR SHOULD BE NOTIFIED IMMEDIATELY OF ANY DISCREPANCY. THIS DRAWING IS COPYRIGHT AND REMAINS THE PROPERTY ROGER PARRY & PARTNERS.

Rev	Description	Date	Dr by	App by
Original				

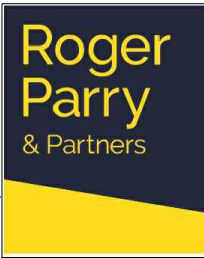

Residential - Agricultural - Commercial

Job	Proposed egg production unit at Upper Bryn		
Title	Highway Plan		
Location	Upper Bryn Abermule Powys SY15 6LW		
Client	W L Hamer		
Scales	1:250 @ A1		
Drawing No.	GEJ/SB/003B		
Drawn by	SAB	Date	09/06/2022

HOGSTOW HALL, MINSTERLEY
SHREWSBURY, SHROPSHIRE, SY5 0HZ
Tel: 01743 791336 Fax: 01743 792770
email: mail@rogerparry.net
Web address: www.rogerparry.net

Roger Parry & Partners LLP partnership no OC31220
Registered Office: Hogstow Hall, Minsterley, Shrewsbury, SY5 0HZ
Registered in England and Wales
A list of members of the LLP is available at the above address.