

- Application Site Boundary
- Adjacent Land in Client's Ownership
- Public Right of Way

0m 20m 40m 60m 80m 100m

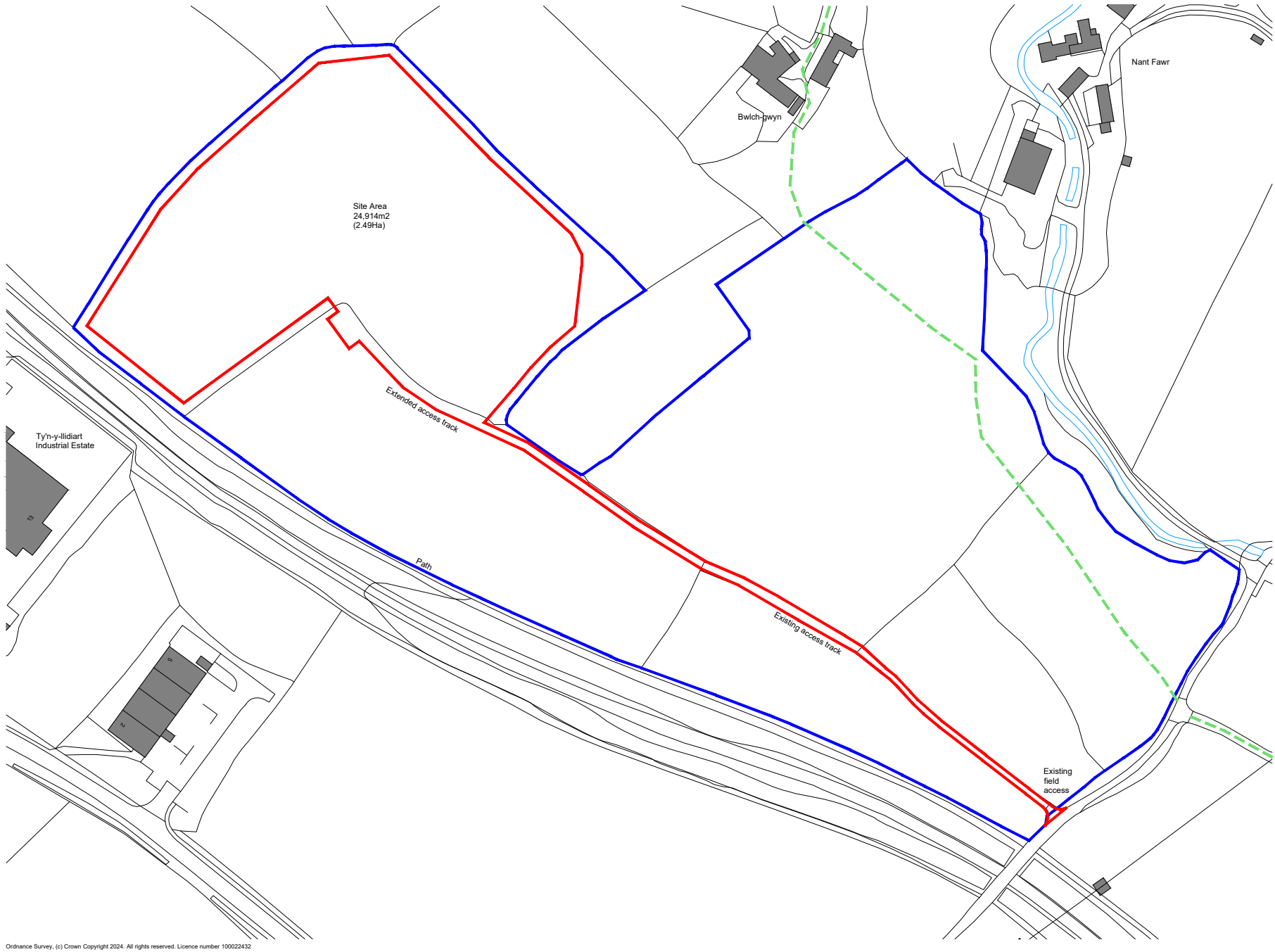

Ordnance Survey, (c) Crown Copyright 2024. All rights reserved. Licence number 100022432

THIS DRAWING IS TO BE READ IN CONJUNCTION WITH ALL RELATED DRAWINGS. ALL DIMENSIONS MUST BE CHECKED AND VERIFIED ON SITE BEFORE COMMENCING ANY WORK OR PRODUCING SHOP DRAWINGS. THE ORIGINATOR SHOULD BE NOTIFIED IMMEDIATELY OF ANY DISCREPANCY. THIS DRAWING IS COPYRIGHT AND REMAINS THE PROPERTY ROGER PARRY & PARTNERS.

Rev	Description	Date	By
-	-	year/mm/dd	--



Residential - Agricultural - Commerical

Project	Proposed Solar Array		
Drawing Title	Location Plan		
Location	Land at Trewyn Bach, Corwen, LL21 9RR		
Client	M Budgen		
Scale	1:2500 @ A3		
Drawing No	77025 / GH / 001	Rev	-
Drawn By	NB	Date	2024/08/12

MERCIAN HOUSE, 9 DARWIN COURT, OXON
BUSINESS PARK, SHREWSBURY, SY3 5HJ
Tel: 01743 791336
E-mail: mail@rogerparry.net
Web address: www.rogerparry.net
Roger Parry & Partners LLP partnership no.OC312203
Registered in England and Wales.
A list of members of the LLP is available at the above address.