

THIS DRAWING IS TO BE READ IN CONJUNCTION WITH ALL RELATED DRAWINGS. ALL DIMENSIONS MUST BE CHECKED AND VERIFIED ON SITE BEFORE COMMENCING ANY WORK OR PRODUCING SHOP DRAWINGS. THE ORIGINATOR SHOULD BE NOTIFIED IMMEDIATELY OF ANY DISCREPANCY. THIS DRAWING IS COPYRIGHT AND REMAINS THE PROPERTY OF ROGER PARRY & PARTNERS.

Rev	Description	Date	By
-	-	year/mm/dd	--

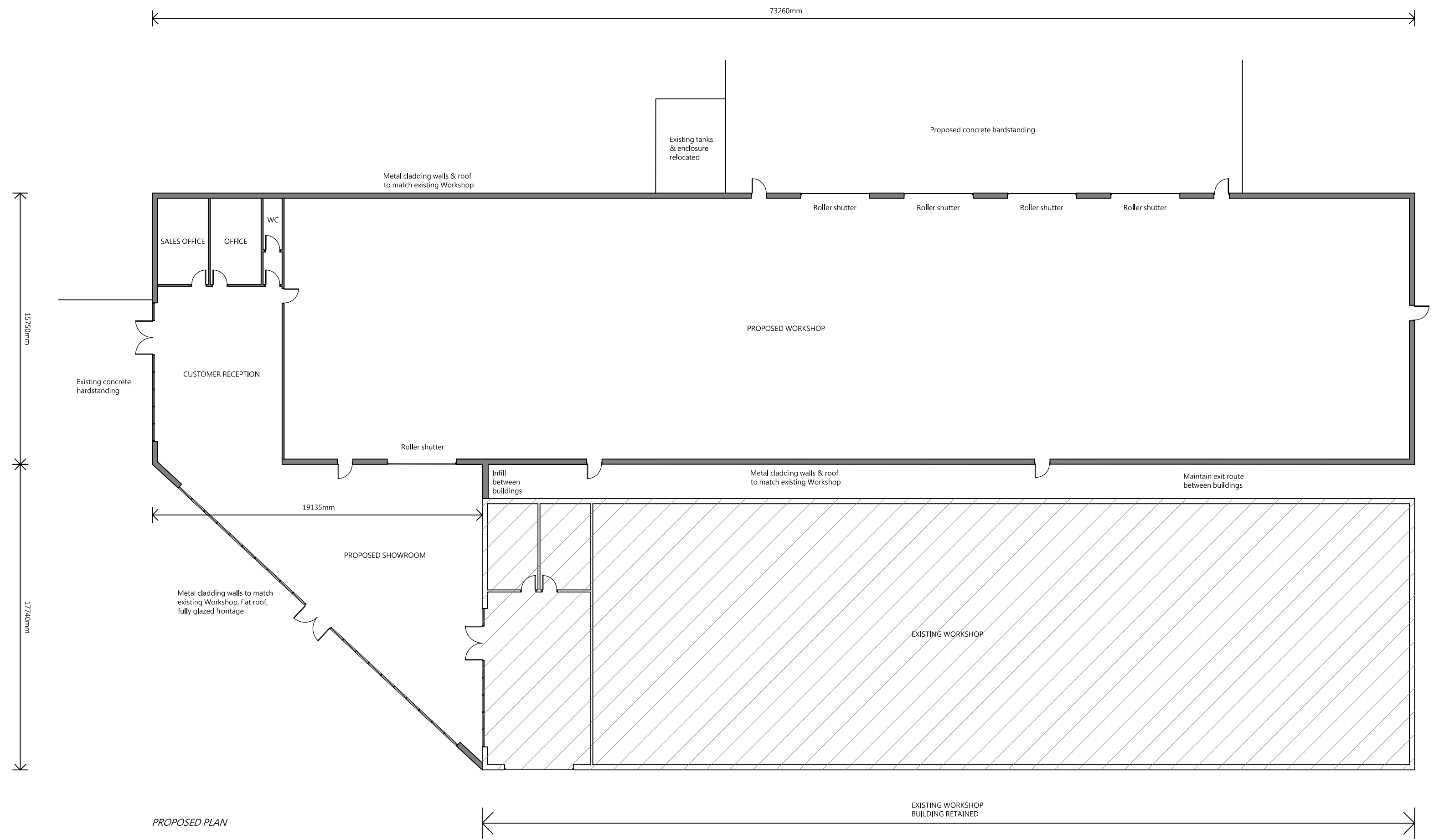

PROPOSED PLAN



Residential - Agricultural - Commercial			
Project	Proposed Workshop & Showroom		
Drawing Title	Proposed Plan		
Location	Charles Stores, Coed Y Dinas, Welshpool, SY21 8RP		
Client	Charles Stores Ltd		
Scale	1:200 @ A2		
Drawing No	76594 / RJC / 100	Rev	-
Drawn By	NB	Date	2022/07/15

HOGSTOW HALL, MINSTERLEY  
 SHREWSBURY, SHROPSHIRE. SY5 0HZ  
 Tel: 01743 791336 Fax: 01743 792770  
 E-mail: mail@rogerparry.net  
 Web address: www.rogerparry.net  
 Roger Parry & Partners LLP partnership no. OC312203  
 Registered Office Hogstow Hall, Minsterley, Shrewsbury, SY5 0HZ  
 Registered in England and Wales.  
 A list of members of the LLP is available at the above address.