



MANURE MANAGEMENT PLAN



DEVELOPMENT: Erection of an extension to a free range egg production unit including silos and associated works

LOCATION: Pertherin
Pontdolgoch
Caersws
Powys
SY17 5NJ

CLIENT: Gwynne Hughes & Son

Roger Parry & Partners LLP
The Estates Office, 20 Salop Road, Oswestry, Shropshire, SY11 2NU
Tel: 01691655334 Fax: 01691 657798
Email: richard@rogerparry.net

*Also at: 11 Severn Street, Welshpool, Powys, SY21 7AG
Tel: 01938 554499 Fax: 01938 554462
email: welshpool@rogerparry.net*

*Also at: Hogstow Hall, Minsterley, Shrewsbury, SY5 0HZ
Tel: 01743 791336 Fax: 01743 792770
email: mail@rogerparry.net*

August 2019



The Estates Office
20 Salop Road
Oswestry
SY11 2NU

Phone 01691 655334

richard@rogerparry.net
www.rogerparry.net

Offices also at Minsterley & Welshpool

MANURE MANAGEMENT PLAN

The Manure Management Plan has calculated the areas that are available to spread manure.

The Hughes Family farm Pertherin, Pontdolgoch extends to excess of 250 acres as one unit.

The Total Farmed Area is 250.00 acres

The Arable Area & Grassland Area available to spread is 101.00 hectares

The farm is not within a NVZ area and therefore for grassland the maximum Kg/ha N = 300kg

101.00 hectares x 300kg = 30,300 kg N

Total 30,300 kg N

Therefore the Maximum amount of Total manure N that can be applied over the whole of the farms is 30,300 kg N.

The total N produced from 16,000 Laying Hens is 14,720 kg Total N.

The total N produced from 400 Ewes is 3,040 kg Total N

The total N produced from 100 Dairy Cows is 10,100 kg Total N.

Therefore no kg N will have to be exported.

A map is provided in the full plan which shows Red Areas where manure spreading should not take place.

The manure spreading areas overlap with a C2 flood risk area along the Afon Carno. Under the Codes of Good Agricultural Practice organic manure can be spread on land unless:

- The soil is waterlogged, flooded, frozen hard or snow covered, or
- there is a significant risk of nitrogen getting into surface water via run-off, taking into account in particular the slope of the land, weather conditions, ground cover, proximity to surface waters, soil conditions and the presence of land drains.

Contingency Plan

There are a number of covered areas on the farm to allow for storing any manure, slurry and dirty water produced at times when spreading may not be possible e.g. due to wet, waterlogged or frozen conditions in accordance with the Code of Good Agricultural Practice. This is to ensure manures and slurry are spread at appropriate times to prevent pollution and maximise uptake of nutrients for crop growth. Manure will also be exported off site to local AD plants.

Areas on which solid manures and slurry should never be spread are:

Ditches and watercourses:

- Within at least 10 metres (11 yards) of either side of any watercourse including ditches and piped ditches. This will avoid direct spreading into the watercourse and also reduce the risk of run-off reaching the watercourse. Do not forget to include watercourses that form the boundary of your farm.



The Estates Office
20 Salop Road
Oswestry
SY11 2NU

Phone 01691 655334

richard@rogerparry.net
www.rogerparry.net

Offices also at Minsterley & Welshpool

Other non-spreading (red) areas:

- Within at least 50 metres (55 yards) of any spring, well, borehole or reservoir that supplies water for human consumption or farm dairies.
- Very steep slopes where run-off is a high risk throughout the year.
- Any areas where you may not be allowed to spread for reasons such as a tenancy agreement, an abatement notice due to smell, set-aside land, Sites of Special Scientific Interest (SSSIs) or Environmentally Sensitive Areas (ESAs).
- The surface is rocky or uneven so that your equipment cannot be used effectively or safely.

APPLICATION METHODS

Manures will be stored and spread in accordance with the water, soil and air Codes of Good Agricultural Practice.

Manures will be stored in field stores and manure heaps at Pertherin on arable ground and will be densely packed with a A shaped profile.

- Manure heaps will be well away from water courses, drainage schemes and ditches.
- Manure will be spread under suitable conditions
 - Wind direction will be chosen to be blowing with prevailing direction from the west which will blow any odours away from the closest dwellings.
 - The ground to receive the manure will not be water logged or frozen.
 - Spreading will be done at least 10 metres away from any water courses or ditches
- There is a covered concrete pad at Pertherin that can be used for emergency storage when conditions are not suitable to store manure on the fields. This shed has a dirty water system and has an impermeable base the shed used to be used for wintering cattle.
- Manure will be incorporated in the soil within 24 hours of application, where this is possible due to conditions.

MANURE SPREADING PLAN

Manure will be spread according to the annual cropping plan.

Manure will be tested and analysed on a regular basis so that quantities applied will mean that applications will concur with crop requirements as laid out in DEFRA document RB209.



The Estates Office
20 Salop Road
Oswestry
SY11 2NU

Phone 01691 655334

richard@rogerparry.net
www.rogerparry.net

Offices also at Minsterley & Welshpool

3	4395	0.33
3	4949	2.30
3	5062	0.72
3	5099	1.94
3	5170	0.76
13	5283	2.41
13	6534	5.63
13	6959	2.33
13	7653	0.60
13	8036	5.24
13	8057	0.22
13	8069	1.28
13	8102	5.79
13	8177	0.47
13	8614	1.59
13	8658	1.01
13	9168	1.48
13	9546	3.08
194	3701	0.80
194	6327	2.92
194	7233	2.49
194	7643	2.33
194	7812	1.56
192	2496	5.94
192	6933	2.31
192	7841	2.09
192	8052	1.29
192	8476	2.18
192	8648	0.48
192	8884	0.42
192	9161	2.48
192	9574	0.45
193	0363	1.74
193	0435	3.94
193	1223	5.70
193	1553	1.98
al		34.17

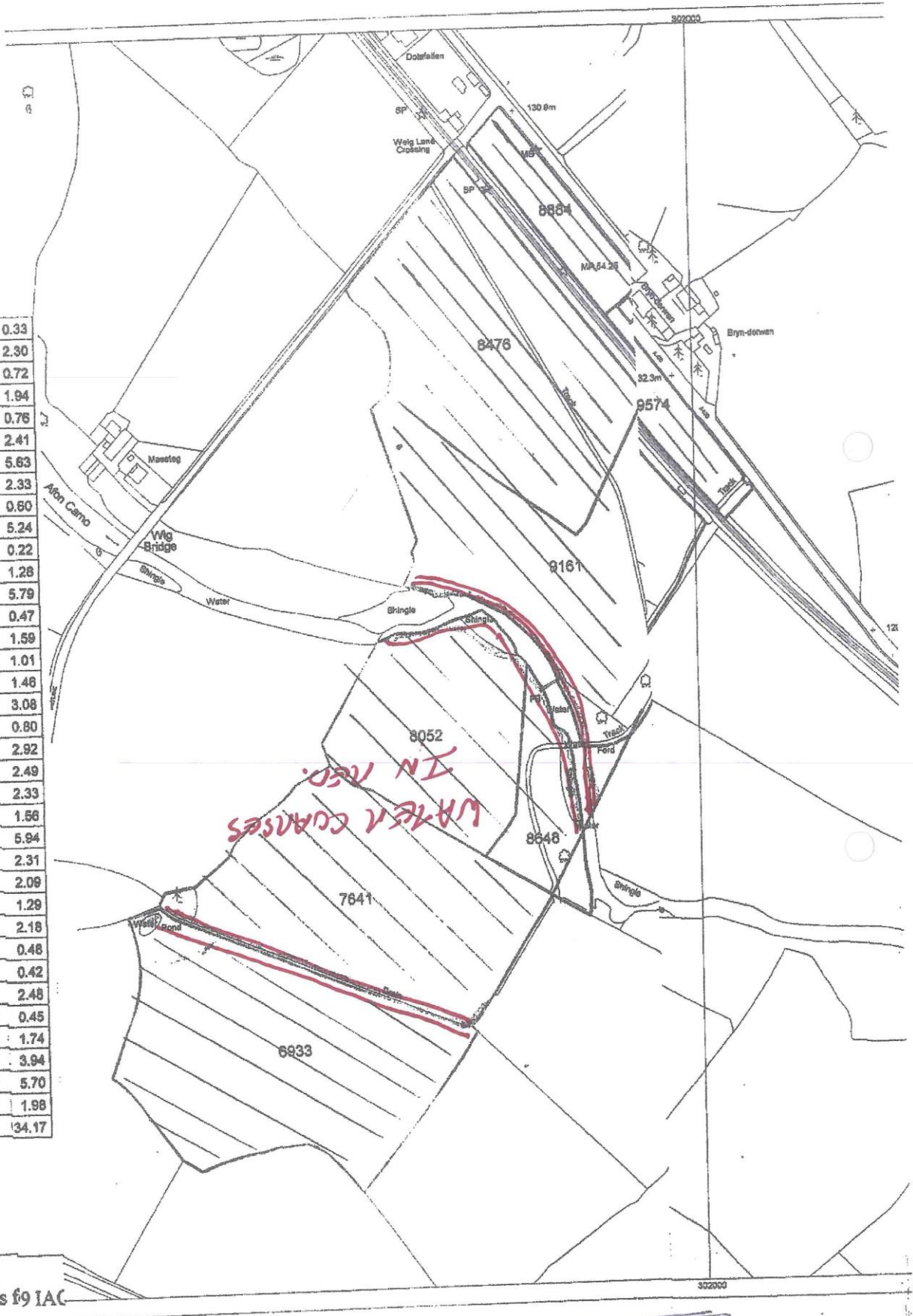

- Fields f9 IAC

EXTRA



The Estates Office
20 Salop Road
Oswestry
SY11 2NU

Phone 01691 655334

richard@rogerparry.net
www.rogerparry.net

Offices also at Minsterley & Welshpool