



MANURE MANAGEMANT PLAN



DEVELOPMENT:	Erection of a Free Range Egg Production Unit including silos and associated works
LOCATION:	Bron Parc Galltegfa Llanfwrog Ruthin Denbighshire LL15 2AR
CLIENT:	Jones Brothers

Roger Parry & Partners LLP
The Estates Office, 20 Salop Road, Oswestry, Shropshire, SY11 2NU
Tel: 01691655334 Fax: 01691 657798
Email: richard@rogerparry.net

*Also at: 1 Berriew Street, Welshpool, Powys, SY21 7SQ
Tel: 01938 554499 Fax: 01938 554462
email: welshpool@rogerparry.net*

*Also at: Hogstow Hall, Minsterley, Shrewsbury, SY5 0HZ
Tel: 01743 791336 Fax: 01743 792770
email: mail@rogerparry.net*

September 2018



The Estates Office
20 Salop Road
Oswestry
SY11 2NU

Phone 01691 655334

richard@rogerparry.net
www.rogerparry.net

*Offices also at Minsterley &
Welshpool*

MANURE MANAGEMENT PLAN

This manure management plan has been prepared for Jones Brothers of Bron Parc Farm, Galltegfa, Llanfwrog, Ruthin, Denbighshire, LL15 2AR.

The farm extends to approximately 1000 acres (404.69 hectares) of owner occupied and rented land. The farm currently have a flock of 2,000 ewes and 250 beef cattle, with 32,000 hens proposed. The applicants currently buy in fertiliser to spread on the land.

The manure management plan has been prepared for the total stock of 2,000 ewes, 250 beef cattle and 32,000 free range laying hens.

A buffer of 10m has been provided to all watercourses, and no spreading will be done on this buffer zone. The farm has therefore sufficient capacity to dispose of all manure produced by all enterprises in accordance with all the relevant regulations and legislation.

The total amount of manure (N) that can be applied over the spreadable land on the farm would be $369.08 \text{ hectares} \times 250\text{kg} = 92,270\text{kg N}$.

The total produced on the farm is 52,170kg N, which is well below the threshold, and therefore no manure will have to be exported (Table 1).

Table 1:

Stock Unit	Stock Numbers	Kg N per Stock Unit	Total Kg N Produced
1 ewe	2000	13	26,000
1 beef cattle	250	33	8,250
Free range hens (1,000 places)	32	560	17,920
Total Kg N produced			52,170

Therefore no kg N will have to be exported.

A map is provided in the full plan which shows Red Areas where manure spreading should not take place.

Contingency Plan

There are a number of covered areas on the farm to allow for storing any manure, slurry and dirty water produced at times when spreading may not be possible e.g. due to wet, waterlogged or frozen conditions in accordance with the Code of Good Agricultural Practice. This is to ensure manures and slurry are spread at appropriate times to prevent pollution and maximise uptake of nutrients for crop growth. Manure will also be exported off site to local AD plants.

Areas on which solid manures and slurry should never be spread are:

Ditches and watercourses:

- Within at least 10 metres (11 yards) of either side of any watercourse including ditches and piped ditches. This will avoid direct spreading into the watercourse and also reduce the risk of run-off reaching the watercourse. Do not forget to include watercourses that form the boundary of your farm.

Other non-spreading (red) areas:

- Within at least 50 metres (55 yards) of any spring, well, borehole or reservoir that supplies water for human consumption or farm dairies.



The Estates Office
20 Salop Road
Oswestry
SY11 2NU

Phone 01691 655334

richard@rogerparry.net
www.rogerparry.net

Offices also at Minsterley &
Welshpool

- Very steep slopes where run-off is a high risk throughout the year.
- Any areas where you may not be allowed to spread for reasons such as a tenancy agreement, an abatement notice due to smell, set-aside land, Sites of Special Scientific Interest (SSSIs) or Environmentally Sensitive Areas (ESAs).
- The surface is rocky or uneven so that your equipment cannot be used effectively or safely.

APPLICATION METHODS

Manures will be stored and spread in accordance with the water, soil and air Codes of Good Agricultural Practice.

Manures will be stored in field stores and manure heaps at Bron Parc Farm on arable ground and will be densely packed with a A shaped profile.

- Manure heaps will be well away from water courses, drainage schemes and ditches.
- Manure will be spread under suitable conditions
 - Wind direction will be chosen to be blowing with prevailing direction from the west which will blow any odours away from the closest dwellings.
 - The ground to receive the manure will not be water logged or frozen.
 - Spreading will be done at least 10 metres away from any water courses or ditches
- There is a covered concrete pad at Bron Parc Farm that can be used for emergency storage when conditions are not suitable to store manure on the fields. This shed has a dirty water system and has an impermeable base the shed used to be used for wintering cattle.
- Manure will be incorporated in the soil within 24 hours of application, where this is possible due to conditions.

MANURE SPREADING PLAN

Manure will be spread according to the annual cropping plan.

Manure will be tested and analysed on a regular basis so that quantities applied will mean that applications will concur with crop requirements as laid out in DEFRA document RB209.

Table 2

Total Manure Production			
Group	Kg N Produced	No of Animals	Total Kg N
Ewes	13	2000	26,000
Beef cattle	33	250	8,250
Laying hens 1000	560	32,000	17,920
Total N Produced			52,170 Kg N
Total N Exported			0 Kg N
Spreadable Area			369.08 Ha
Total N/Ha			141.35 kg N/Ha



The Estates Office
20 Salop Road
Oswestry
SY11 2NU

Phone 01691 655334

richard@rogerparry.net
www.rogerparry.net

Offices also at Minsterley & Welshpool

MANURE SPREADING PLAN

The birds within the free range unit will graze the designated land in a rotational field system. The birds will step out of the building through the pop holes provided and onto a veranda, which shall ensure that the ground is not poached and compacted by the birds. The veranda shall also ensure that the feet of the birds are cleaned prior to entering the building. The birds will be then directed to those fields available for grazing in rotation to prevent over stocking of the ground and ensure the fertility of soil. Good pasture management is essential, and it is paramount the problems of parasitic intestinal worms and coccidian oocysts are avoided.



The Estates Office
20 Salop Road
Oswestry
SY11 2NU

Phone 01691 655334

richard@rogerparry.net
www.rogerparry.net

*Offices also at Minsterley &
Welshpool*



Key licence number GD 0100021874. Use of this data is subject to [terms](#)
08/09/2018.

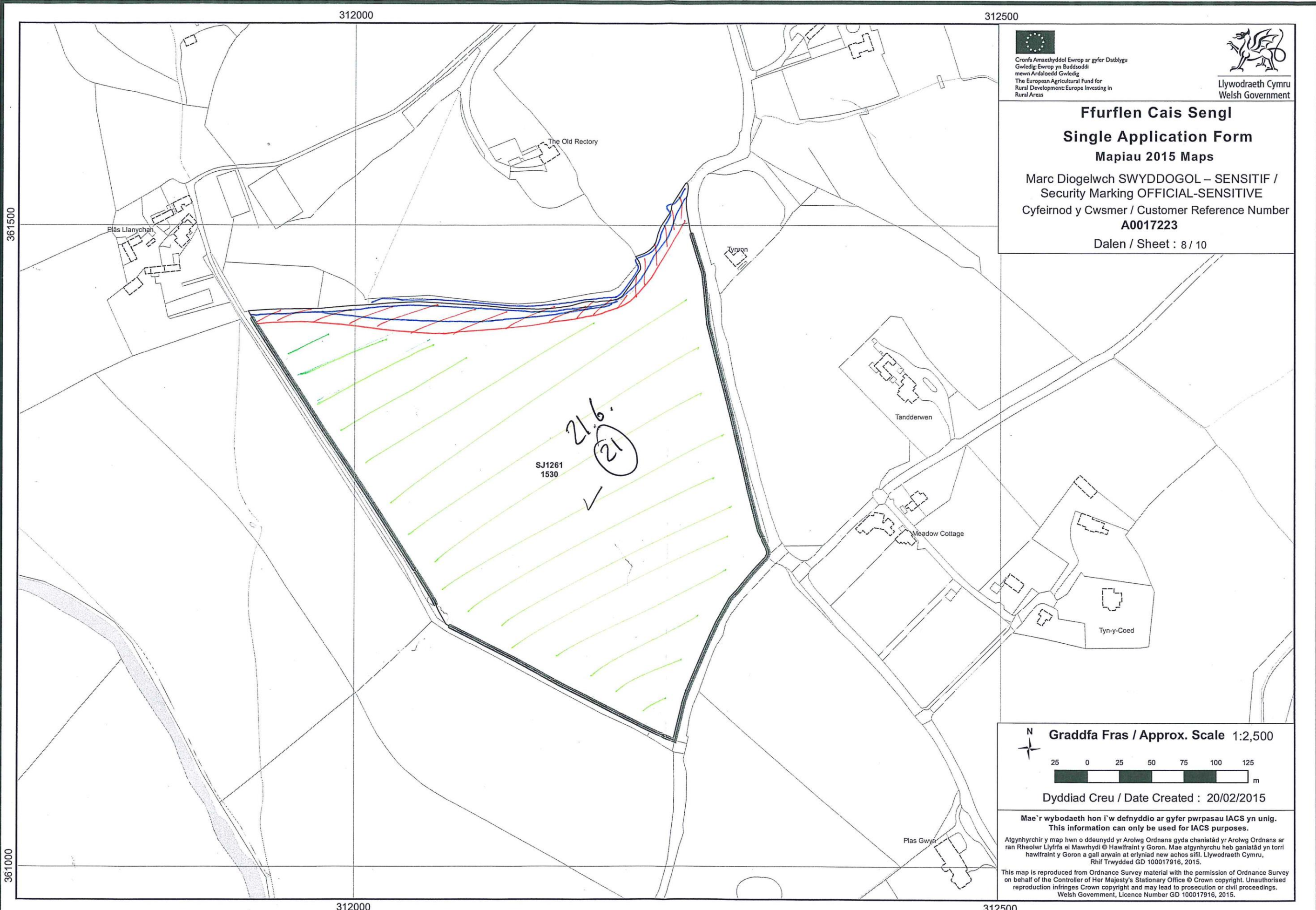

Cronfa Amaethyddol Ewrop ar gyfer Datblygu
Gwledig Ewrop yn Buddsoddi
mewn Ardaloedd Gwledig
The European Agricultural Fund for
Rural Development: Europe Investing in
Rural Areas



Llywodraeth Cymru
Welsh Government

Ffurflen Cais Sengl
Single Application Form
Mapiau 2015 Maps

Marc Diogelwch SWYDDOGOL – SENSITIF /
Security Marking OFFICIAL-SENSITIVE
Cyfeirnod y Cwsmer / Customer Reference Number
A0017223

Dalen / Sheet : 8 / 10



Graddfa Fras / Approx. Scale 1:2,500

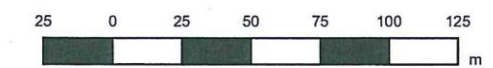

Dyddiad Creu / Date Created : 20/02/2015

Mae'r wybodaeth hon i'w defnyddio ar gyfer pwrpasau IACS yn unig.
This information can only be used for IACS purposes.
Atgynhychir y map hwn o ddeunydd yr Arolwg Ordnans gyda chaniatâd yr Arolwg Ordnans ar
ran Rheolwr Llyfrfa ei Mawrhydi © Hawffrains y Goron. Mae atgynhychu heb ganiatâd yn torri
hawffrains y Goron a gall arwain at erlyniad new achos sifil. Llywodraeth Cymru,
Rhif Trwydded GD 100017916, 2015.
This map is reproduced from Ordnance Survey material with the permission of Ordnance Survey
on behalf of the Controller of Her Majesty's Stationary Office © Crown copyright. Unauthorised
reproduction infringes Crown copyright and may lead to prosecution or civil proceedings.
Welsh Government, Licence Number GD 100017916, 2015.