



MANURE MANAGEMENT PLAN



DEVELOPMENT: Erection of a Free Range Egg Production Unit including silos and associated works

LOCATION: Cyniwyl
Llanerfyl
Welshpool
Powys
SY21 0EX

CLIENT: Bennett Partners

Roger Parry & Partners LLP
The Estates Office, 20 Salop Road, Oswestry, Shropshire, SY11 2NU
Tel: 01691655334 Fax: 01691 657798
Email: richard@rogerparry.net

*Also at: 1 Berriew Street, Welshpool, Powys, SY21 7SQ
Tel: 01938 554499 Fax: 01938 554462
email: welshpool@rogerparry.net*

*Also at: Hogstow Hall, Minsterley, Shrewsbury, SY5 0HZ
Tel: 01743 791336 Fax: 01743 792770
email: mail@rogerparry.net*

March 2018



The Estates Office
20 Salop Road
Oswestry
SY11 2NU

Phone 01691 655334

richard@rogerparry.net
www.rogerparry.net

Offices also at Minsterley & Welshpool

MANURE MANAGEMENT PLAN

This manure management plan has been prepared for Bennett Partners of Cyniwyl, Llanerfyl, Welshpool, Powys, SY21 0EX.

The farm extends to approximately 179 acres (72 hectares) of owner occupied land. The farm currently has no livestock with 32,000 hens proposed.

The manure management plan has been prepared for the total stock of 32,000 free range laying hens.

A buffer of 10m has been provided to all watercourses, and no spreading will be done on this buffer zone. The farm has therefore sufficient capacity to dispose of all manure produced by all enterprises in accordance with all the relevant regulations and legislation.

The total amount of manure (N) that can be applied over the spreadable land on the farm would be 68 hectares x 250kg = 17,000kg N.

The total produced on the farm is 17,920kg N, and therefore 920kg N will have to be exported (Table 1).

Table 1:

Stock Unit	Stock Numbers	Kg N per Stock Unit	Total Kg N Produced
1000 laying hens	32	560	17,920
Total Kg N produced			17,920

The manure storage and disposal will also need to accord with DEFRA's Code of Good Agricultural Practice for the Protection of Air, Water and Soil.

Contingency Plan

There are a number of covered areas on the farm to allow for storing any manure, slurry and dirty water produced at times when spreading may not be possible e.g. due to wet, waterlogged or frozen conditions in accordance with the Code of Good Agricultural Practice. This is to ensure manures and slurry are spread at appropriate times to prevent pollution and maximise uptake of nutrients for crop growth. Manure will also be exported off site to local AD plants.

Measures will be put in place for the storage of wash water during and after disease outbreak.

Any contaminated wash water will be stored in containers separate from other manures, and will be disposed of by a specialist contractor licensed to deal with such wastes.

Table 2

Total Manure Production			
Group	Kg N Produced	No of Animals	Total Kg N
Laying hens 1000	560	32	17,920
Total N Produced			17,920 Kg N



The Estates Office
20 Salop Road
Oswestry
SY11 2NU

Phone 01691 655334

richard@rogerparry.net
www.rogerparry.net

Offices also at Minsterley & Welshpool

Total N Exported			920
Spreadable Area			68 Ha
Total N/Ha			250kg N/Ha

Areas on which solid manures and slurry should never be spread are:

Ditches and watercourses:

- Within at least 10 metres (11 yards) of either side of any watercourse including ditches and piped ditches. This will avoid direct spreading into the watercourse and also reduce the risk of run-off reaching the watercourse. Do not forget to include watercourses that form the boundary of your farm.

Other non-spreading (red) areas:

- Within at least 50 metres (55 yards) of any spring, well, borehole or reservoir that supplies water for human consumption or farm dairies.
- Very steep slopes where run-off is a high risk throughout the year.
- Any areas where you may not be allowed to spread for reasons such as a tenancy agreement, an abatement notice due to smell, set-aside land, Sites of Special Scientific Interest (SSSIs) or Environmentally Sensitive Areas (ESAs).
- The surface is rocky or uneven so that your equipment cannot be used effectively or safely.

APPLICATION METHODS

Manures will be stored and spread in accordance with the water, soil and air Codes of Good Agricultural Practice.

Manures will be stored in field stores and manure heaps at Cyniwyll on pasture ground and will be densely packed with an 'A' shaped profile.

- Manure heaps will be well away from water courses, drainage schemes and ditches.
- Manure will be spread under suitable conditions
 - Wind direction will be chosen to be blowing with prevailing direction from the west which will blow any odours away from the closest dwellings.
 - The ground to receive the manure will not be water logged or frozen.
 - Spreading will be done at least 10 metres away from any water courses or ditches
- There is a covered concrete pad at Cyniwyll that can be used for emergency storage when conditions are not suitable to store manure on the fields. This shed has a dirty water system and has an impermeable base the shed used to be used for wintering cattle.
- Manure will be incorporated in the soil within 24 hours of application, where this is possible due to conditions.

MANURE SPREADING PLAN

Manure will be spread according to the annual cropping plan.

Manure will be tested and analysed on a regular basis so that quantities applied will mean that applications will concur with crop requirements as laid out in DEFRA document RB209.

The birds within the free range unit will graze the designated land in a rotational field system. The birds will step out of the building through the pop holes provided and onto a veranda, which shall ensure that the ground is not poached and compacted by the birds. The veranda shall also ensure that the feet of the birds are cleaned prior to entering the building. The birds will be then directed to those fields available for



The Estates Office
20 Salop Road
Oswestry
SY11 2NU

Phone 01691 655334

richard@rogerparry.net
www.rogerparry.net

Offices also at Minsterley & Welshpool

grazing in rotation to prevent over stocking of the ground and ensure the fertility of soil. Good pasture management is essential, and it is paramount the problems of parasitic intestinal worms and coccidian oocysts are avoided.



The Estates Office
20 Salop Road
Oswestry
SY11 2NU

Phone 01691 655334

richard@rogerparry.net
www.rogerparry.net

*Offices also at Minsterley &
Welshpool*

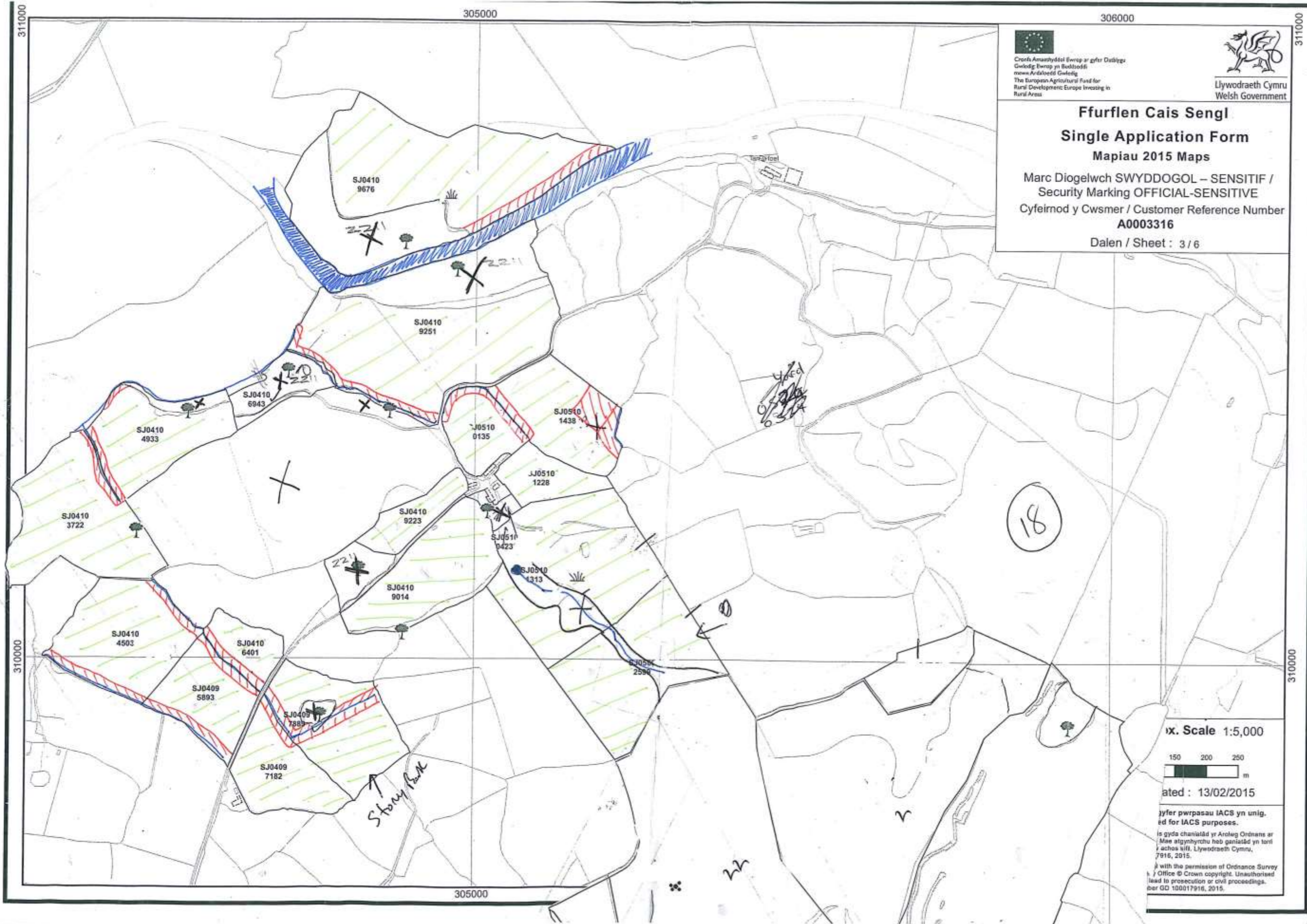



 Cwmwl Amgwyddol Ewrop ar gyfer Ddiwygi
 Gwledol Ewrop yn Bwlltodi
 mewn Ardaloedd Gwledol
 The European Agricultural Fund for
 Rural Development: Europe Investing in
 Rural Areas

 Llywodraeth Cymru
 Welsh Government

Ffurflen Cais Sengl
Single Application Form
Mapiau 2015 Maps

Marc Diogelwch SWYDDOGOL – SENSITIF /
 Security Marking OFFICIAL-SENSITIVE
 Cyfeirnod y Cwsmer / Customer Reference Number
A0003316
 Dalen / Sheet : 3 / 6

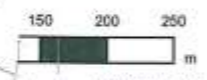
ix. Scale 1:5,000



dated : 13/02/2015

yfyr pwrpasau IACS yn unig.
 ed for IACS purposes.

Is gyda chaniatâd yr Aroleg Ordnans ar
 Mae atgynhyrchu heb ganiatâd yn torri
 achos sifft. Llywodraeth Cymru,
 7916, 2015.

with the permission of Ordnance Survey
 Office © Crown copyright. Unauthorised
 lead to prosecution or civil proceedings.
 der GO 100017916, 2015.

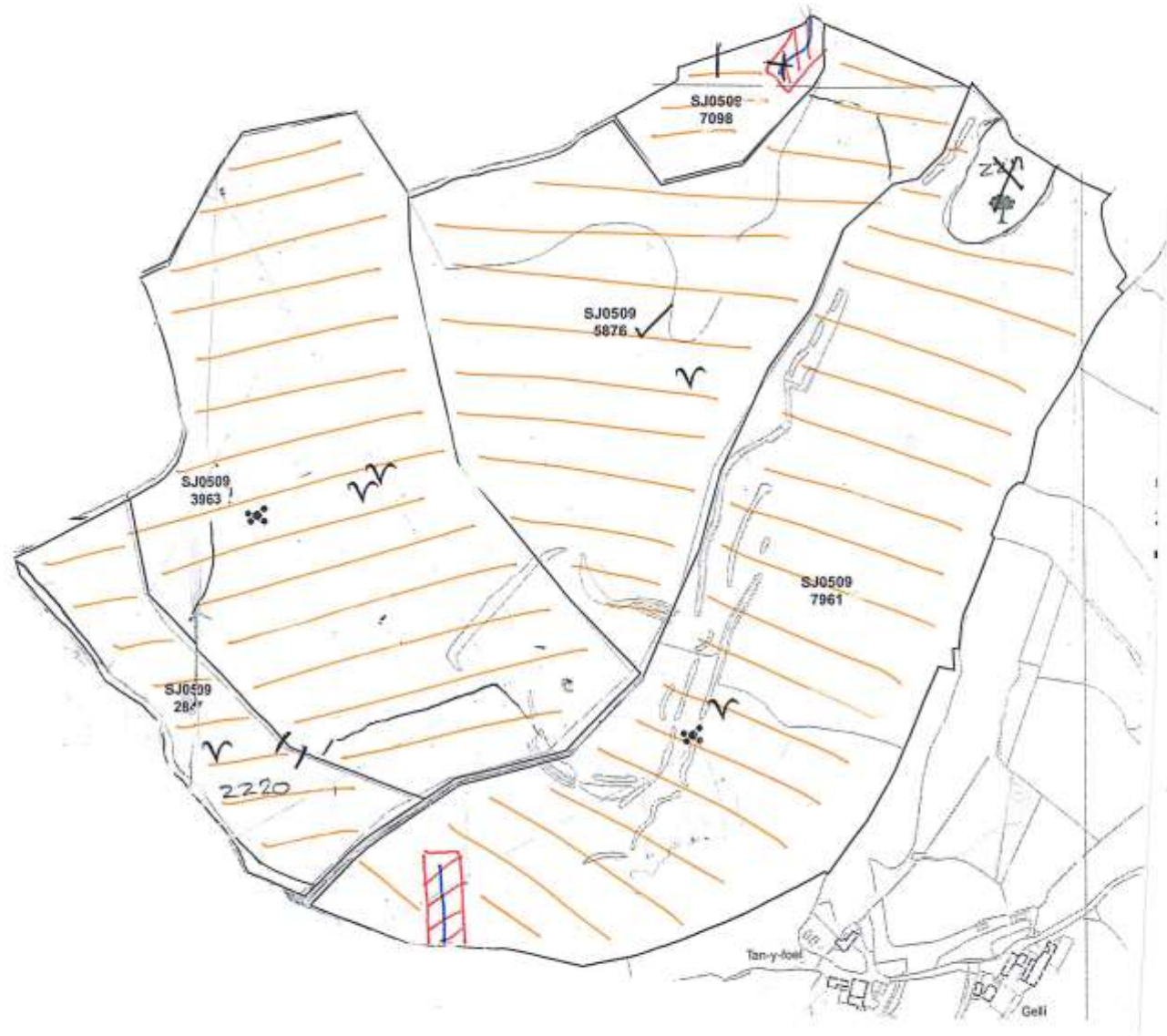

SJ0508
7098

SJ0509
5876

SJ0509
3963

SJ0509
2847

SJ0509
7961

2220

Tan-y-fael

Gelli